

KUGGREMSHJUL PROFIL AT

TIMINGBELT PULLEYS PROFILE AT

Material: Aluminium med
stållänsar
Material: Aluminium with
steel flanges

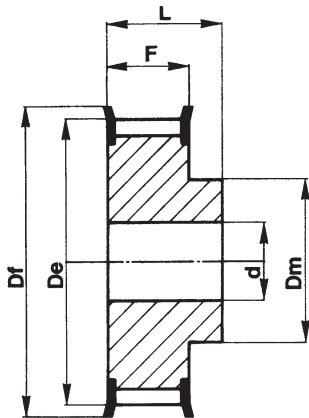

Typ / Type 6F

AT10 För rembredd 16mm / For Belt width 16mm

Best Nr. Code	Typ Type	Tandantal No. of teeth	De	Df	Dm	F	L	d
31AT10/15-2	6F	15	45.90	51	31	21	31	8
31AT10/16-2	6F	16	49.05	54	35	21	31	8
31AT10/18-2	6F	18	55.45	60	40	21	31	8
31AT10/19-2	6F	19	58.60	67	44	21	31	8
31AT10/20-2	6F	20	61.80	67	46	21	31	8
31AT10/22-2	6F	22	68.15	70	52	21	31	8
31AT10/24-2	6F	24	74.55	83	58	21	31	8
31AT10/25-2	6F	25	77.70	83	60	21	31	8
31AT10/26-2	6F	26	80.90	87	60	21	31	8
31AT10/27-2	6F	27	84.10	91	60	21	31	8
31AT10/28-2	6F	28	87.25	93	60	21	31	8
31AT10/30-2	6F	30	93.65	97	60	21	31	8
31AT10/32-2	6F	32	100.00	112	65	21	31	10
31AT10/36-2	6F	36	112.75	120	70	21	31	10
31AT10/40-2	6F	40	125.45	135	80	21	31	10
31AT10/44-0	6	44	138.20	-	88	21	31	10
31AT10/48-0	6	48	150.95	-	95	21	31	16
31AT10/60-0	6	60	189.10	-	110	21	31	16

AT10 För rembredd 25mm / For Belt width 25mm

Best Nr. Code	Typ Type	Tandantal No. of teeth	De	Df	Dm	F	L	d
40AT10/15-2	6F	15	45.90	51	32	30	40	8
40AT10/16-2	6F	16	49.05	54	35	30	40	8
40AT10/18-2	6F	18	55.45	60	40	30	40	8
40AT10/19-2	6F	19	58.60	67	44	30	40	8
40AT10/20-2	6F	20	61.80	67	46	30	40	8
40AT10/22-2	6F	22	68.15	70	52	30	40	8
40AT10/24-2	6F	24	74.55	83	58	30	40	8
40AT10/25-2	6F	25	77.70	83	60	30	40	8
40AT10/26-2	6F	26	80.90	87	60	30	40	8
40AT10/27-2	6F	27	84.10	91	60	30	40	8
40AT10/28-2	6F	28	87.25	93	60	30	40	8
40AT10/30-2	6F	30	93.65	97	60	30	40	8
40AT10/32-2	6F	32	100.00	112	65	30	40	10
40AT10/36-2	6F	36	112.75	120	70	30	40	10
40AT10/40-2	6F	40	125.45	135	80	30	40	10
40AT10/44-0	6	44	138.20	-	88	30	40	10
40AT10/48-0	6	48	150.95	-	95	30	40	16
40AT10/60-0	6	60	189.10	-	110	30	40	16

AT10 För rembredd 32mm / For Belt width 32mm

Best Nr. Code	Typ Type	Tandantal No. of teeth	De	Df	Dm	F	L	d
47AT10/18-2	6F	18	55.45	60	40	37	47	10
47AT10/19-2	6F	19	58.60	67	44	37	47	10
47AT10/20-2	6F	20	61.80	67	46	37	47	12
47AT10/22-2	6F	22	68.15	75	52	37	47	12
47AT10/24-2	6F	24	74.55	83	58	37	47	12
47AT10/25-2	6F	25	77.70	83	60	37	47	12
47AT10/26-2	6F	26	80.90	87	60	37	47	12
47AT10/27-2	6F	27	84.10	91	60	37	47	12
47AT10/28-2	6F	28	87.25	94	60	37	47	12
47AT10/30-2	6F	30	93.65	97	60	37	47	12
47AT10/32-2	6F	32	100.00	106	65	37	47	12
47AT10/36-2	6F	36	112.75	120	70	37	47	16
47AT10/40-2	6F	40	125.45	135	80	37	47	16
47AT10/44-0	6	44	138.20	-	88	37	47	16
47AT10/48-0	6	48	150.95	-	95	37	47	16
47AT10/60-0	6	60	189.10	-	110	37	47	16

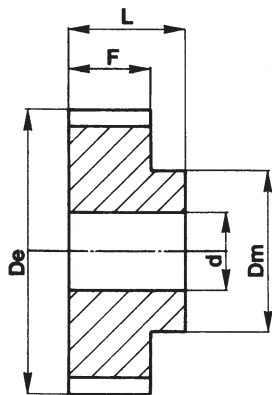

Typ / Type 6

AT10 För rembredd 50mm / For Belt width 50mm

Best Nr. Code	Typ Type	Tandantal No. of teeth	De	Df	Dm	F	L	d
66AT10/18-2	6F	18	55.45	60	40	56	66	10
66AT10/19-2	6F	19	58.60	67	44	56	66	10
66AT10/20-2	6F	20	61.80	67	46	56	66	12
66AT10/22-2	6F	22	68.15	75	52	56	66	12
66AT10/24-2	6F	24	74.55	83	58	56	66	12
66AT10/25-2	6F	25	77.70	83	60	56	66	12
66AT10/26-2	6F	26	80.90	87	60	56	66	12
66AT10/27-2	6F	27	84.10	91	60	56	66	12
66AT10/28-2	6F	28	87.25	94	60	56	66	12
66AT10/30-2	6F	30	93.65	97	60	56	66	12
66AT10/32-2	6F	32	100.00	106	65	56	66	12
66AT10/36-2	6F	36	112.75	120	70	56	66	16
66AT10/40-2	6F	40	125.45	135	80	56	66	16
66AT10/44-0	6	44	138.20	-	88	56	66	16
66AT10/48-0	6	48	150.95	-	95	56	66	16
66AT10/60-0	6	60	189.10	-	110	56	66	16