

# KUGGREMSHJUL PROFIL T

## TIMINGBELT PULLEYS PROFILE T

Material: Aluminium med  
stålflansar  
Material: Aluminium with  
steel flanges

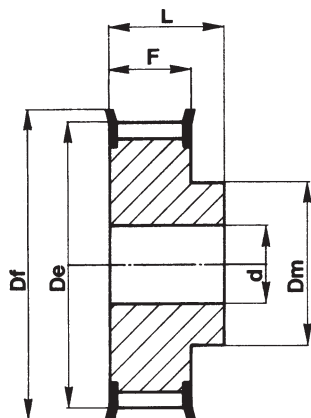

Typ / Type 6F

### T10 För rembredd 16mm / For Belt width 16mm

Best Nr. Code	Typ Type	Tandantal No. of teeth	De	Df	Dm	F	L	d
31T10/12-2	6F	12	36.35	43	28	21	31	6
31T10/14-2	6F	14	42.70	48	32	21	31	8
31T10/15-2	6F	15	45.90	51	32	21	31	8
31T10/16-2	6F	16	49.05	54	35	21	31	8
31T10/18-2	6F	18	55.45	60	40	21	31	8
31T10/19-2	6F	19	58.60	67	44	21	31	8
31T10/20-2	6F	20	61.80	67	46	21	31	8
31T10/24-2	6F	24	74.55	83	58	21	31	8
31T10/25-2	6F	25	77.70	83	60	21	31	8
31T10/27-2	6F	27	84.10	91	60	21	31	8
31T10/30-2	6F	30	93.65	97	60	21	31	8
31T10/32-2	6F	32	100.00	112	65	21	31	10
31T10/36-2	6F	36	112.75	120	70	21	31	10
31T10/40-2	6F	40	125.45	135	80	21	31	10
31T10/48-2	6	48	150.95	-	95	21	31	16
31T10/60-2	6	60	189.10	-	110	21	31	16

### T10 För rembredd 25mm / For Belt width 25mm

Best Nr. Code	Typ Type	Tandantal No. of teeth	De	Df	Dm	F	L	d
40T10/12-2	6F	12	36.35	43	28	30	40	6
40T10/14-2	6F	14	42.70	48	32	30	40	8
40T10/15-2	6F	15	45.90	51	32	30	40	8
40T10/16-2	6F	16	49.05	54	35	30	40	8
40T10/18-2	6F	18	55.45	60	40	30	40	8
40T10/19-2	6F	19	58.60	67	44	30	40	8
40T10/20-2	6F	20	61.80	67	46	30	40	8
40T10/24-2	6F	24	74.55	83	58	30	40	8
40T10/25-2	6F	25	77.70	83	60	30	40	8
40T10/27-2	6F	27	84.10	91	60	30	40	8
40T10/30-2	6F	30	93.65	97	60	30	40	8
40T10/32-2	6F	32	100.00	112	65	30	40	10
40T10/36-2	6F	36	112.75	120	70	30	40	10
40T10/40-2	6F	40	125.45	135	80	30	40	10
40T10/48-2	6	48	150.95	-	95	30	40	16
40T10/60-2	6	60	189.10	-	110	30	40	16

### T10 För rembredd 32mm / For Belt width 32mm

Best Nr. Code	Typ Type	Tandantal No. of teeth	De	Df	Dm	F	L	d
47T10/18-2	6F	18	55.45	60	40	37	47	10
47T10/19-2	6F	19	58.60	66	44	37	47	10
47T10/20-2	6F	20	61.80	66	46	37	47	12
47T10/22-2	6F	22	68.15	75	52	37	47	12
47T10/24-2	6F	24	74.55	83	58	37	47	12
47T10/25-2	6F	25	77.70	83	60	37	47	12
47T10/26-2	6F	26	80.90	87	60	37	47	12
47T10/27-2	6F	27	84.10	91	60	37	47	12
47T10/28-2	6F	28	87.25	93	60	37	47	12
47T10/30-2	6F	30	93.65	97	60	37	47	12
47T10/32-2	6F	32	100.00	106	65	37	47	12
47T10/36-2	6F	36	112.75	119	70	37	47	16
47T10/40-2	6F	40	125.45	131	80	37	47	16
47T10/44-2	6	44	138.20	-	88	37	47	16
47T10/48-2	6	48	150.95	-	95	37	47	16
47T10/60-2	6	60	189.10	-	100	37	47	16

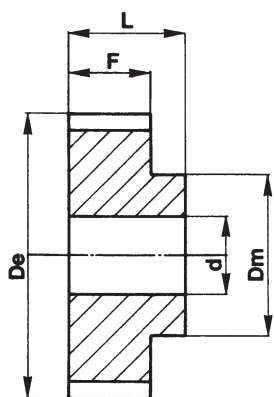

Typ / Type 6

### T10 För rembredd 50mm / For Belt width 50mm

Best Nr. Code	Typ Type	Tandantal No. of teeth	De	Df	Dm	F	L	d
66T10/18-2	6F	18	55.45	60	40	55	66	10
66T10/19-2	6F	19	58.60	67	44	56	66	10
66T10/20-2	6F	20	61.80	67	46	56	66	12
66T10/24-2	6F	24	74.55	83	58	56	66	12
66T10/25-2	6F	25	77.70	83	60	56	66	12
66T10/27-2	6F	27	84.10	91	60	56	66	12
66T10/30-2	6F	30	93.65	97	60	56	66	12
66T10/32-2	6F	32	100.00	112	65	56	66	12
66T10/36-2	6F	36	112.75	120	70	56	66	16
66T10/40-2	6F	40	125.45	135	80	56	66	16
66T10/48-2	6	48	150.95	-	95	56	66	16
66T10/60-2	6	60	189.10	-	110	56	66	16